

Probe renovation

Do this only when a message on the display tells you so, typically every 6 or 12 months.

STEP 1:



Remove the Membrane Protector by pulling it straight downwards.

STEP 2:

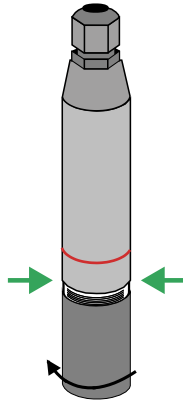

Gently unscrew the Membrane Cap. Make sure to unscrew at the correct place (green arrows).

STEP 3:

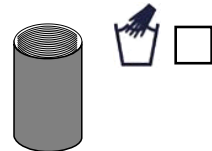

Wash and dry the Membrane Cap.

STEP 4:

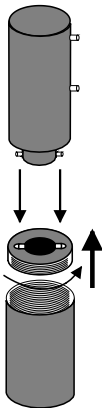

Use the Handy Tool to remove the Membrane Retainer Ring from the Membrane Cap.

STEP 5:

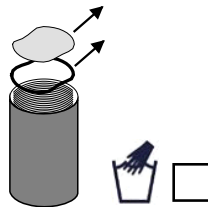

Remove the membrane and the O-ring from the Membrane Cap. Wash and dry the empty Membrane Cap as well as the Membrane Retainer Ring.

STEP 6:

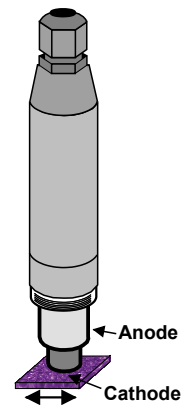

Gently clean the cathode with the sponge and use a soft brush, for instance an old tooth brush to remove any white deposit from the anode.

STEP 7:

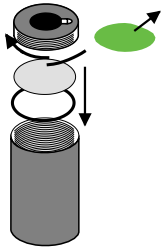

First place the new O-ring, then the membrane and finally the Membrane Retainer Ring in the Membrane Cap. Ensure that the membrane does not wrinkle. Please remember to remove the green protecting paper from the membrane.

STEP 8:

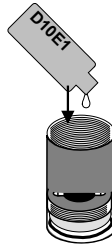

Fill the Membrane Cap with electrolyte.

STEP 9:

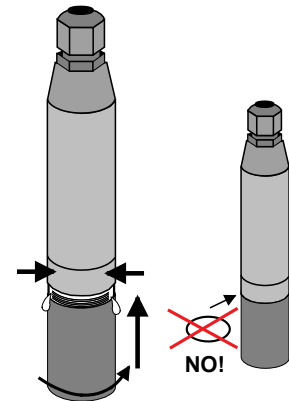

Screw the Membrane Cap back onto the probe. **There is no O-ring between the Membrane Cap and the rest of the probe!** Please be careful not to tighten the membrane cap too hard.

STEP 10:

Wait a few hours and then make a calibration. The probe takes time to settle down, you might get an error message "Probe output too high" if you try to calibrate immediately. Check the calibration during the next few days.

OxyGuard International A/S

Farum Gydevej 64
3520 Farum, Denmark
www.oxyguard.dk
oxyguard@oxyguard.dk

www.oxyguard.dk

